

Before your first use, please make sure the battery is fully charged via the included AC adapter and cable.

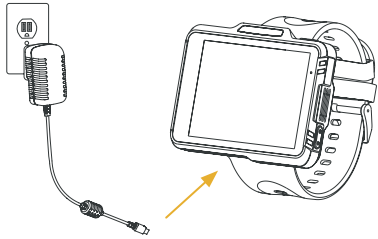

1

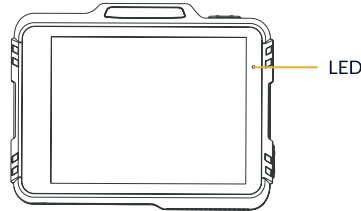

## Charging LED / Battery status

Blue LED on	Fully charged
Red LED on	Charging in progress
Red LED flashes	Low-battery alert

2

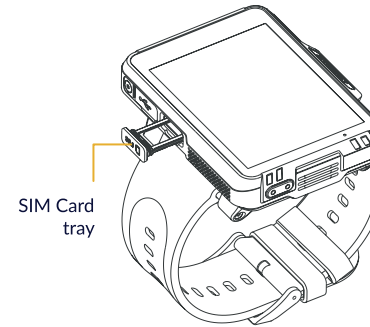

- 1 Pull the tray out from the slot then place the SIM card in it.
- 2 Gently push the tray back into the slot until it locks into place.

*Remark: Please install the SIM Card with its metal contacts facing towards the screen to avoid damage.*

5

- 1 Do not charge the device in a hot or humid environment. The temperature will affect the charging efficiency.
- 2 The terminal contains a built-in battery. Please do not try to replace it yourself in order to avoid damage.
- 3 Do not use the terminal's wireless functionalities where wireless device use is prohibited or where it may cause interference or danger, such as in mines or gas stations.
- 4 Use only a dry, soft cloth to clean the terminal. Cleaning with a wet cloth or other chemical cleaners may deform and shorten the service life of the keypad and shell of the terminal.
- 5 The temperature should not be too low or high during use. This could cause malfunction. Please use the terminal under the permitted temperature.
- 6 If the terminal is damaged due to a drop or water, contact the service center. Do not try to repair it yourself.

6

# Appearance

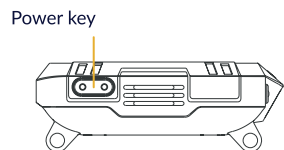
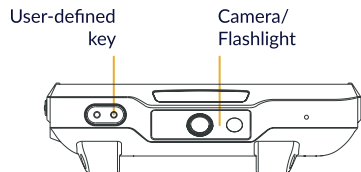
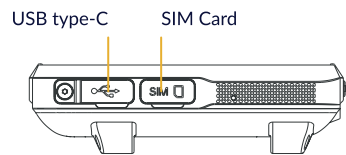

3

# Quick settings

## Power key

- 1 When the terminal is powered off, hold down the power key for 3 seconds to switch the terminal on.
- 2 When the terminal is powered on, briefly press the power key to lock the screen.

## User-defined key

- 1 The user-defined key will be set as "Home Key" by default.
- 2 To reset the user-defined key: go to "Quick Setting" > "Key Map", then set the parameters per your needs.

## Touch the screen

- 1 Back to previous page: swipe inward from the left or right edge of the screen.
- 2 Back to the desktop: swipe the screen from bottom to top.
- 3 Switch to new task: swipe the screen from bottom to top, then hold on until the recently used apps display.

4

# Support information

For more information and technical support, please visit [newland-id.com/contact](http://newland-id.com/contact)



## WD1

Name: WD1-NW10 Watch Scanner  
 Manufacturer: Newland EMEA  
 All technical information are subject to the actual performance, Newland reserve the right of final explanations.  
 PN: 1060090482

Newland Europe BV  
 Rolweg 25  
 4104 AV Culemborg  
 The Netherlands



7



**WD1**  
 Watch Scanner

